

# MILKPAL

Consistent hot and cold milk foam without steam

- > Smooth and creamy texture
- > Precise temperature control
- > Continuous brewing
- > Automated cleaning

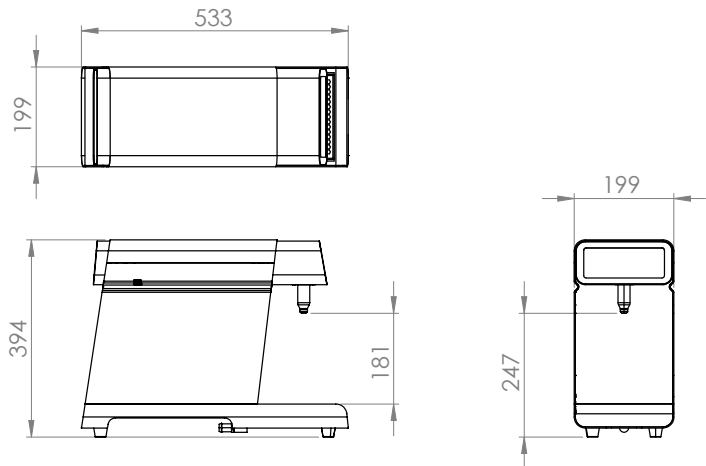

## SPECS

NAME ORDER CODE	DIMENSIONS (D x W x H mm)	SPOUT TO TRAY (H mm)	SERVINGS/ HR	POWER @ 220V	PLUMBING REQS	WEIGHT
MILKPAL 1000090	535 x 195x 388	180	120 (200ml)	15amp 3100W	1/4" push-fit 1 1/2" waste	30kg

## PACKAGING

NAME ORDER CODE	DIMENSIONS (L x W x H mm)	PACKED WEIGHT	QTY / PALLET
MILKPAL 1000090	700 x 540 x 300	35kg*	8

\*Ships on pallet

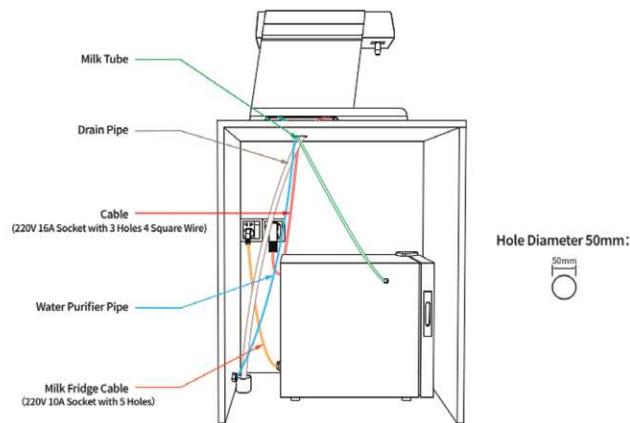

Fridge not included.